



No or Limited Power Instructions - PowerSync+ Cart® 20 or 40 No Power to the Individual Power Module

1. Turn off and unplug the PowerSync+ Cart®.

Open the front doors.



2. To access the individual power cords for the power modules in the PowerSync Cart® 20 or 40, dividers 16 – 20 will have to be removed from the top shelf.

Using your hand pull the divider forward until it releases and can be removed. Continue until all five dividers have been removed.



3. Verify that the power going from the individual power module & to the cart's power supply is fully seated.

In a PowerSync+ 20 cart, there will be one infeed & and in a PowerSync+ 40 there will be two.



4. Verify that the power cord connected to each individual power module from the cart's power supply is fully seated into the power module.

The power cord will be located near the left interior side of the power module.

Repeat the step for PowerSync+ 40 cart's lower power module.

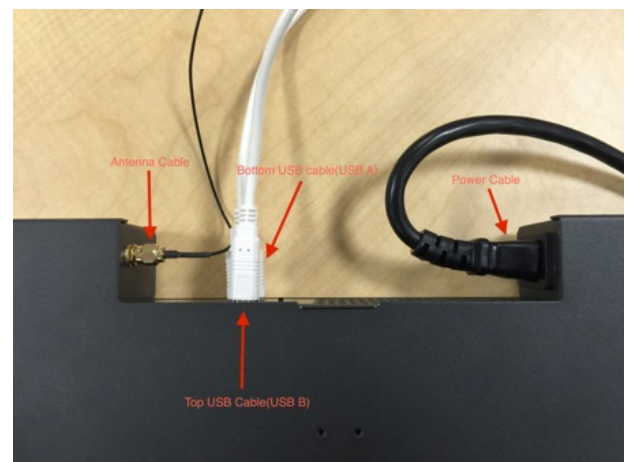
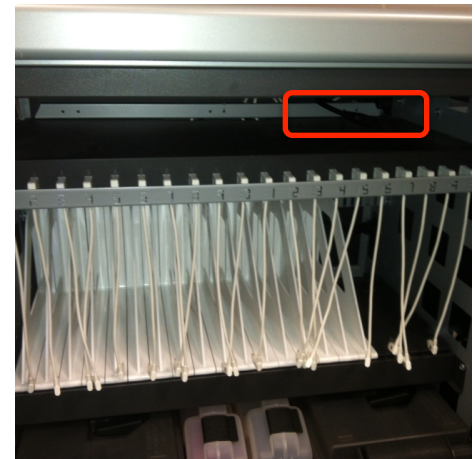

4. Each power module will also have a power switch. In case the individual module is not exhibiting power, please check the power switch.

To locate the power switch, reach on the top of the module near the upper right corner. An opening should be felt and this is where the power switch is located. If the module is not on, flip the switch so the toggle switch is depressed on the upper position of the switch.



6. Once the power cord has been reinserted into the cart's power supply, and the individual power cord is fully seated into the power module, please turn the power to the cart on once again.

The power module's lights should come on to indicate the devices are being charged.

